



# HALL PARK PUBLIC ART MAP





PATRICIA B. MEADOWS



VIRGINIA SHORE

## Craig & Kathryn Hall

Craig Hall's appreciation for the arts began at a very early age. As a teenager, Hall began purchasing art and today, his collection is comprised of hundreds of paintings, sculptures and historically significant photographs by established and emerging artists from around the world.

Craig's wife Kathryn, the former U.S. Ambassador to Austria, shares this love for culture and the arts. While serving in Vienna and throughout their travels, Craig and Kathryn have added to their extensive collection with pieces from Australia, Central Europe, Africa and Asia. Art continues to be an integral component of the Halls' business and personal lives.

## Art Curators

**Patricia B. Meadows** served as the art curator at HALL Park for over 20 years. Meadows worked closely with architects, designers and landscape consultants, and is passionate about contemporary art produced by professional Texas artists.

**Virginia Shore** is a curator, director and advisor, with extensive expertise in contemporary art in all media. Shore has curated more than 200 international exhibitions for public and private collections and has overseen dozens of site-specific commissions. She recently worked with HALL Group to curate a high-profile art collection located in the new development, including HALL Park Hotel, The Monarch, and The Tower at HALL Park.

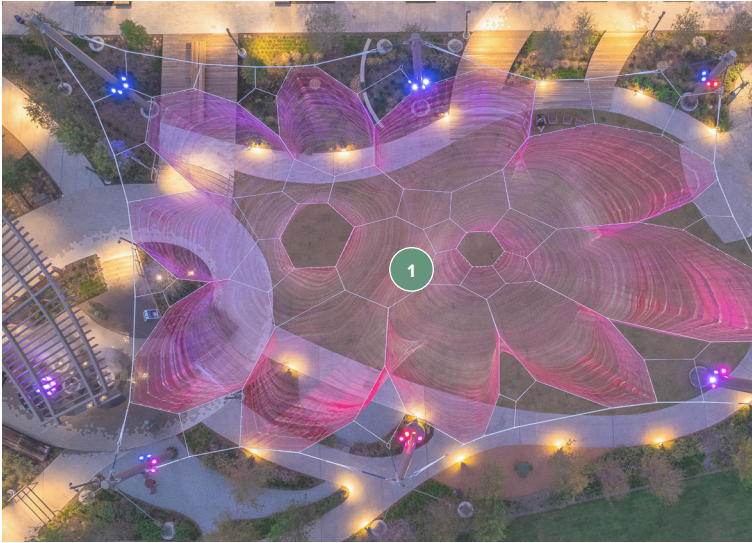

## *Kaleidoscope Park*

Serving as a permanent piece in the City of Frisco's public art collection is a captivating installation titled *Butterfly Rest Stop*, from world-renowned American sculptor and fiber artist Janet Echelman. The pendulous piece hangs over a section of the park and depicts milkweed flowers - a key nutrient to the monarch butterfly's survival and an homage to Frisco's prominence as a corridor for the monarch butterfly migration.



1. **Butterfly Rest Stop**  
Janet Echelman

# Texas Sculpture Garden

A four-acre tract of land at the entrance to HALL Park was reserved as a special tribute to Texas artists and their work. Designed with lakes, water features, native landscaping and walking trails, the outdoor portion of the Texas Sculpture Garden surrounds the lake just outside the 6801 Gaylord Parkway building. The collection continues inside the building's lobby.

1. **4 Ravens, Nevermore #1**  
Joe Barrington, 2000
2. **Saturina - La Rocca**  
Alice Bateman, 1996
3. **Arbor**  
Jim Cinquemani, 2001
4. **Dancers MM**  
Jerry Daniel, 2000
5. **Maternal Caress**  
Eliseo Garcia, 2000
6. **Untitled**  
Tim Glover, 2004
7. **2004-IX**  
Edward Lee Hendricks, 2004
8. **Reincarnation of Farmer Bradley**  
T. Paul Hernandez, 1999
9. **Prairie Falls**  
David B. Hickman, 2001
10. **Jack Rabbits (12)**  
David Iles, 2000
11. **Staples**  
Paul Kittleson, 2001
12. **Quanta: Celtic Spirit Catcher**  
David McCullough, 2000
13. **Dolphin Rhythm**  
John Brough Miller, 1990
14. **La Mujer Roja**  
Michelle O'Michael, 2000
15. **Coming Out of the Circle**  
Sherry Owens, 1999
16. **The Temple Gate**  
Damian Priour
17. **Time Management**  
Zad Roumaya, 2004
18. **The Wiz**  
Art Shirer
19. **Wandering**  
George Tobolowsky, 2016
20. **Blanco #17**  
Mac Whitney, 1985



## 21. INDOOR ARTWORK

**The First Crusade**  
Frances Bagley, 1999

**Bird Window**  
Betsy Bass, Tim Nentrup, 2000

**Texas Bluebonnets**  
Jim Bowman, 2000

**Poetry Series II**  
Roger Colombik, 2000

**Balancing Act**  
Jerry Dodd, 2004

**Art Conference**  
Polly Gessell, 2000

**Two Starched Shirts**  
Joseph Havel, 2001

**Coyote**  
Ken Little, 2000

**Green Ray**  
Heather Marcus, 1996

**Clock Rider**  
Richard Neidhardt, 1996

**Black Bend**  
Tom Orr, 1996

**Wood Bend**  
Tom Orr, 1996

**Grove**  
Sherry Owens, Art Shirer, 1998

**Perseverance**  
Michael Pavlovsky, 2000

**Panther**  
Isaac Smith, 2001

**Figure Aloft**  
James Sullivan, 2001

**Three and Three and Seven Flower**  
James Surls, 1999



*Dancers MM, Jerry Daniel*



*6801 Gaylord Parkway Lobby*

6801 GAYLORD PARKWAY  
FRISCO, TEXAS 75034

GROUP TOURS AVAILABLE BY  
APPOINTMENT 972.377.1100

OUTSIDE ARTWORK:  
OPEN DAILY DAWN TILL DUSK.

INTERIOR ARTWORK:  
OPEN WEEKDAYS 9 AM - 5 PM

[TEXASSCULPTUREGARDEN.ORG](http://TEXASSCULPTUREGARDEN.ORG)

1. **Tar Roses (9)**  
Dennis Oppenheim, 1996
2. **Observe**  
Andrew Rogers, 1987
3. **Texas Horned Toad**  
Joe Barrington, 1999
4. **Growing**  
Andrew Rogers, 1999
5. **Lightning Ball**  
Linda Fleming, 1998
6. **Rhythms of the Metropolis**  
Andrew Rogers, 1996
7. **Marfa I**  
Mac Whitney, 1983
8. **Entry Dancers (2)**  
Jerry Daniel, 2016



1. **Leading**  
Andrew Rogers, 1997
2. **Flora Exemplar**  
Andrew Rogers, 1998
3. **Vacancy**  
Edward Shay, 1998
4. **Monarchs (3)**  
David B. Hickman
5. **Spirit**  
Andrew Rogers, 1998

6. **Sisco**  
Mac Whitney, 1992
7. **Catching Wind**  
Andrew Rogers, 1998
8. **Belger Adjustment**  
Mac Whitney, 1969
9. **Grandmother**  
Colleen Madamombe, 1999
10. **Cartwheel**  
Dominic Benhura, 1999

11. **Handstand**  
Dominic Benhura, 1999
12. **Leapfrog (2)**  
Dominic Benhura, 1999
13. **Running Girl**  
Dominic Benhura, 1999
14. **Swing Me Mama**  
Dominic Benhura, 1999

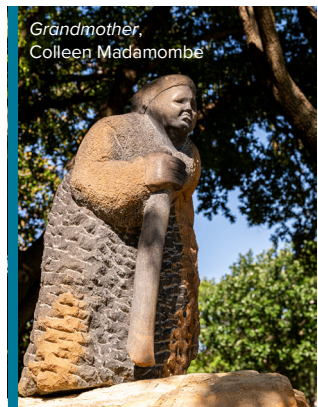

1. **Uvalde**  
Mac Whitney, 2000
2. **Roadrunner with Lizard**  
Joe Barrington, 2000
3. **Oblique Sweep**  
John Brough Miller, 1996
4. **Blue Strake**  
Michelle O'Michael, 2006
5. **Spire with Illusional Balance and Movement**  
John Brough Miller, 2002
6. **Haiku Dancers (11)**  
Jerry Daniel, 1998
7. **Balance**  
Andrew Rogers, 1997
8. **Descending Disk**  
John Brough Miller, 2002
9. **Swimmer**  
David B. Hickman, 2000
10. **Brent's Arch**  
Harry Gordon, 1992

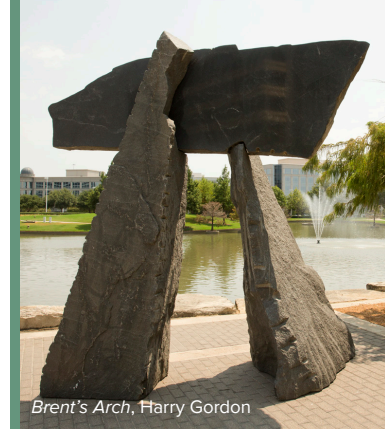
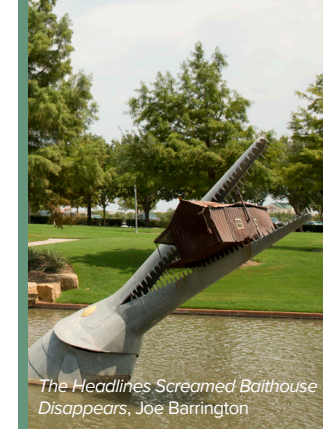

11. **Alligator**  
Robert Tabak
12. **Right Angles #23**  
Gunnar Theel
13. **Blue Guardian**  
David Graeve, 2010
14. **The Headlines Screamed Baithouse Disappears**  
Joe Barrington, 1999
15. **Coil I (Spiral Form A)**  
Andrew Rogers, 1999

16. **The Air We Breathe**  
Andrew Rogers, 2021
17. **Sail Form 1**  
John Brough Miller
18. **Entry Dancers (2)**  
Jerry Daniel, 2016
19. **Nueces**  
Mac Whitney
20. **Growth (Organic D)**  
Andrew Rogers, 1999



1. **Balanced (Organic B)**  
Andrew Rogers, 1999
2. **Evolving**  
Andrew Rogers, 1998
3. **Glacier Stardust Bench**  
Elizabeth Akamatsu, 2017
4. **Borders (4)**  
Steinunn Thorarinsdottir
5. **Jaguar**  
John Henry, 2001
6. **Ascension**  
Russ Connell, 2017
7. **Ripening (Organic E)**  
Andrew Rogers, 1999
8. **Living (Organic II)**  
Andrew Rogers, 1999
9. **Spire**  
John Brough Miller

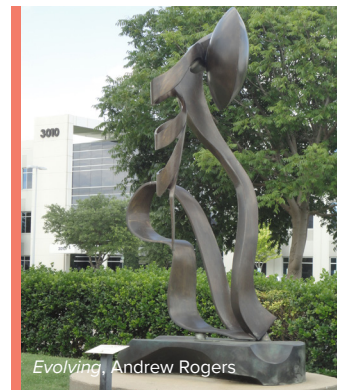

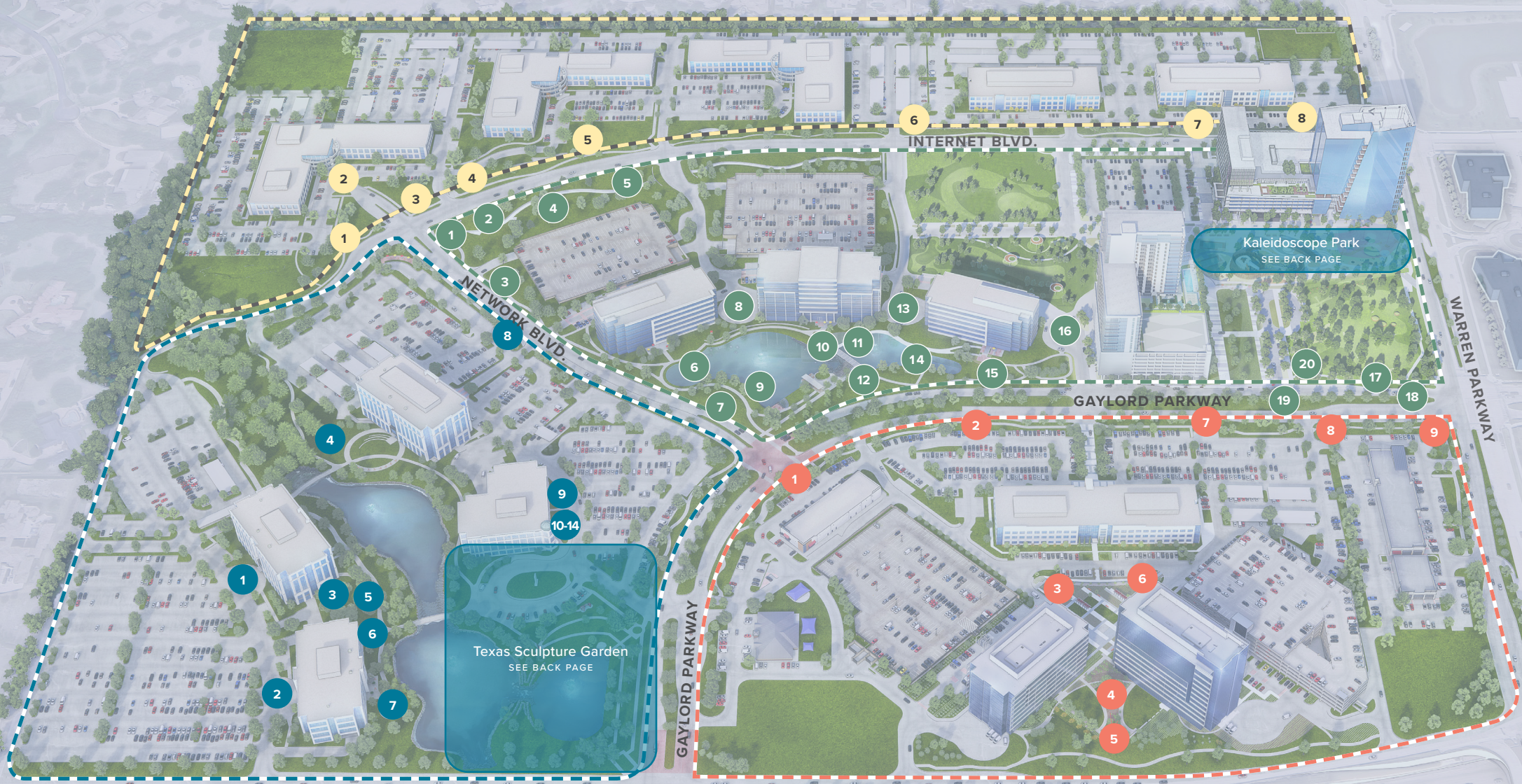

Kaleidoscope Park  
SEE BACK PAGE

Texas Sculpture Garden  
SEE BACK PAGE



HALL PARK

[HALLPARK.COM](http://HALLPARK.COM)